



1ch Active HD-Video UTP Receiver UTP101AR-HD

Feature

- DC12V ~ 36V/AC 9V ~ 24V;
- Real time transfer of PAL、NTSC、SECAM video, HDCVI、AHD、HDTV HD video;
- Recommendation transmission distance as below:
 - 1) HDCVI1080p: 330m; HDCVI 720P: 500m; (passive to active);
 - 2) HDTV 720p/1080p: 300m (passive to active);
 - 3) AHD-L/M 720P/960P: 480m; AHD-H 1080P: 450m (passive to active);
 - 4) Analog video: 650m (passive to active);
- Adopts UTP cable for the transmission, support DIP adjustment;
- Wide range voltage AC/DC power input, strong surge protection and anti-interference performance;
- Delicate design, support MIT rack.

Specification

	Item	Description
Function	Transmission Channel	1ch
	Output	2ch
	Distance	HDCVI: 500m (720p) 330m (1080p), HDTV: 300m (1080p / 720p) AHD: 480m (720p / 960p) 450 (1080p), Analog: 650m
Power	Voltage Range	DC12V~36V or AC 9V~24V
	Power Rate	<1W
Video Transmission	Coaxial Port	Female BNC
	UTP Cable Port	5pin port
	Video System	PAL、NTSC、SECAM video, HDCVI、AHD、HDTV HD video.
	Signal Bandwidth	0~75MHz
	Anti-interference	>75dB
Adj	Adjustment Mode	Rotate
Status	Power LED	Red
	Signal LED	Yellow
Protection	Power Port Protection	2KV/1KA Per: IEC61000-4-5
	Coaxial Port Protection	2KV(different mode) 4KV(common mode) Per:IEC61000-4-5
	ESD	1a contact discharge Level 2 1b air discharge Level 2
Environment	Working Temperature	0°C~55°C
	Storage Temperature	-40°C~85°C
	Humidity	0~95%

The product adopts Cat 5/5e/6 UTP cable as transmission medium, It can receive color or mono PAL/NTSC/SECAM or HDCVI、AHD、HDTV HD video signal in real time. It features long transmission distance, better transmission effect and super anti-interference, which widely used in CCTV surveillance system projects.

Board Diagram

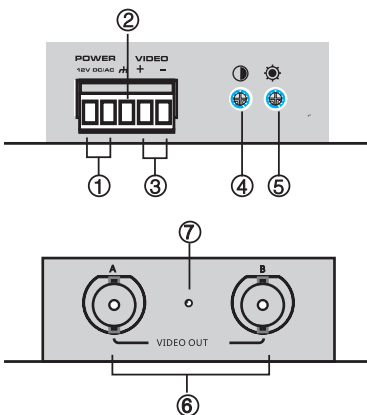

NO.	Component	Description
①	Power supply block	Power supply input
②	Green terminal block	Grounding
③	Green terminal block	For UTP cable
④	switches	For color adjustment
⑤	switches	For brightness adjustment
⑥	BNC-M	Video Output
⑦	MIT Pole	For MIT Installation

Application

